

EA Vertical Series ENGINES





Superior Engines. Second-to-none service. Real time support. All from a name you trust – **Subaru.**

We don't have to tell you that outdoor power equipment is tough stuff. It's tossed around in the back of pickups, thrown on trailers, shoved in sheds and still expected to power through the job. Subaru's EA Series engines are engineered and built specifically for the demanding applications and extreme conditions encountered by outdoor power equipment. From mowers to brush cutters to pressure washers – and everything in between – the EA Series offers easier starts, quieter operation and more power than anything in its class. Featuring advanced chain-driven overhead cam (OHC) technology and our impressive 3-year warranty, it's an easy choice for tough equipment.



More Power. Superior Cooling. Reduced Maintenance. You name it. These engines have it. What sets Subaru apart? A 100 percent original design – no copycats or knock offs – it's genuine Subaru overhead cam technology. Don't worry about the name. Just enjoy the performance.

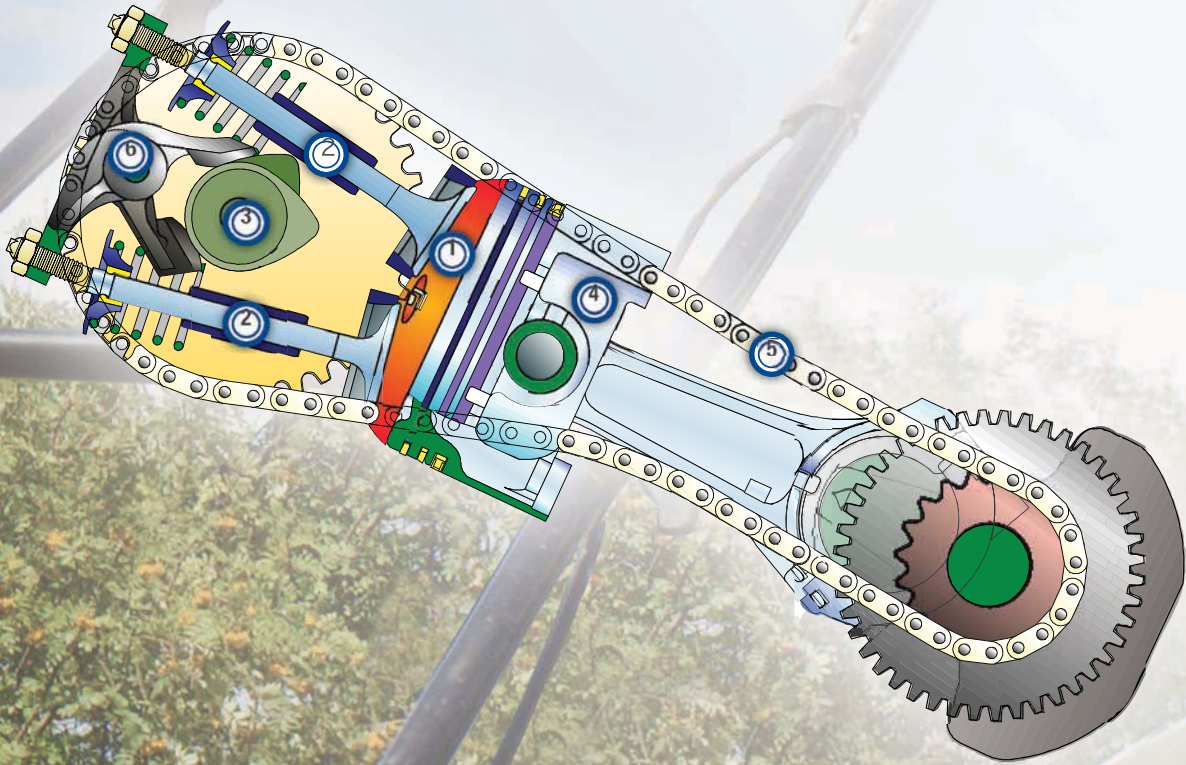

EA Vertical Series Features & Benefits

- ① **Hemispherical Combustion Chamber**
Enables a high compression ratio, providing more power than competitive engines while reducing fuel consumption.
- ② **Intake and Exhaust Valves**
Uniquely positioned to optimize the intake and exhaust ports, and lower the resistance of the air/fuel flow for added power and fuel efficiency, as well as lower emissions.
- ③ **Chain-Driven Overhead Cams (Dual Cams)**
Allow the engine to breathe better and run quieter. OHC technology, in combination with the hemispherical combustion chamber, elevates starting ease and eliminates kickback.
- ④ **Piston and Cast-Iron Cylinder**
Quality components like heavy-duty piston rings and a cast-iron cylinder liner enhance durability.
- ⑤ **Timing Chain**
Hardened steel timing chain reduces maintenance and noise levels. EA engines operate a full 2dBA quieter in exhaust tone than competitors.
- ⑥ **Rocker Arms (2)**
Constructed from hardened steel, rocker arms increase durability and reduce maintenance requirements.

Always read the owner's manual before use.

EA Vertical Series SPECIFICATIONS



	EA175V	EA190V
Type	Chain-Driven OHC	Chain-Driven OHC
Bore X Stroke (mm)	68 x 48	68 x 52
Displacement (cc)	174	189
Maximum Output (HP/RPM)	4.5/3600	5.5/3600
Lubrication Type	Splash with Chain Carry	Splash with Chain Carry
Oil Capacity (oz./cc)	20oz/600cc	20oz/600cc
Fuel Tank Capacity (qt./L)	1 qt./1 L	1 qt./1 L
Dimensions (LxWxH) mm	397" x 350" x 268"	423" x 350" x 288"
Dry Weight (lbs./kg.)	28.6/13	29.7/13.5
Specifications subject to change without notice		

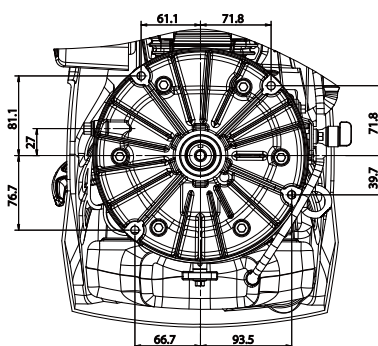
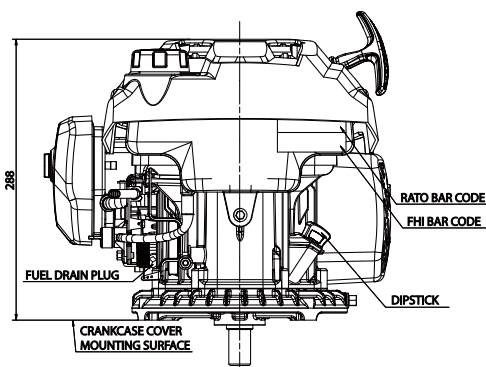
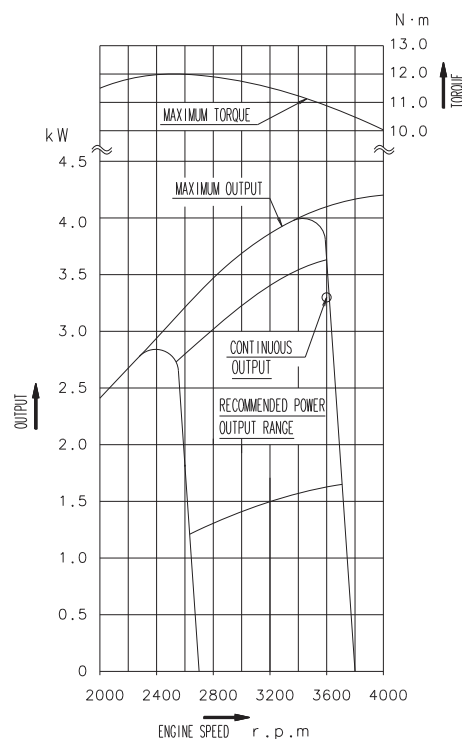
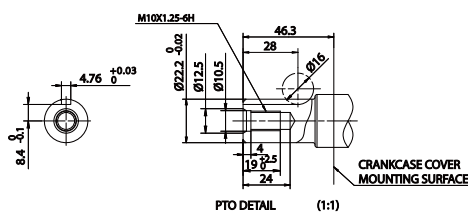
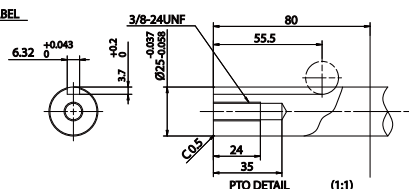
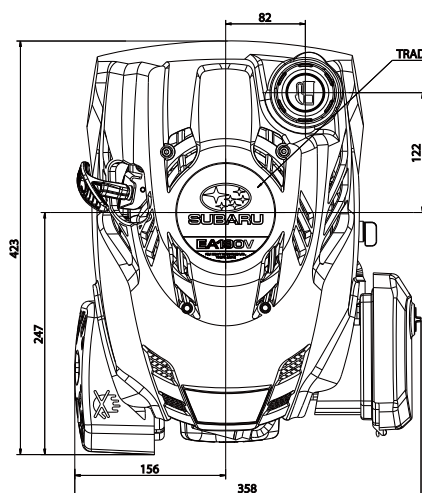

Scan tag for more information



FUJI HEAVY INDUSTRIES LTD.
INDUSTRIAL PRODUCTS COMPANY
 1-1-21, IRIFUNE, CHUO-KU, TOKYO 104-0042, JAPAN
 TEL: +81-3-6228-3657, FAX: +81-3-3553-7114
<http://www.subaru-robin.jp>

Using an engine indoors can kill you in minutes!
 Engine exhaust contains carbon monoxide. This is a
 poison you cannot see or smell. Never use inside a home
 or garage, even if doors and windows are open. Only use
 outside and far away from windows, doors and vents.